

File ref - L:\Bedfordshire Highways\Highways\Engineering\707508 - Rural Match Fund\Rural Match Fund 2014\CAD\Work Area\Live Drgs\08 Flitton & Greenfield (ped routes)\Base drawing.dwg

### NOTES

Rev	Revision details	Chkd	Appd	Date
Drawn: <i>GA</i>	Preliminary			
Design: <i>GA</i>	For comment			
Chkd: <i>GA</i>	For tender			
Appd: <i>GA</i>	For construction			
Date: <i>31/6/14</i>	As constructed			
	Other			



Client

Project Name  
**Rural match Fund -  
Greenfield Road, Flitton**

Drawing Title  
**Proposed raised table.**

Original Drg Size : A4	Dimensions : -
Scale : NTS	Copyright © Amey
Drawing No	Rev
<b>BH/707508/01</b>	

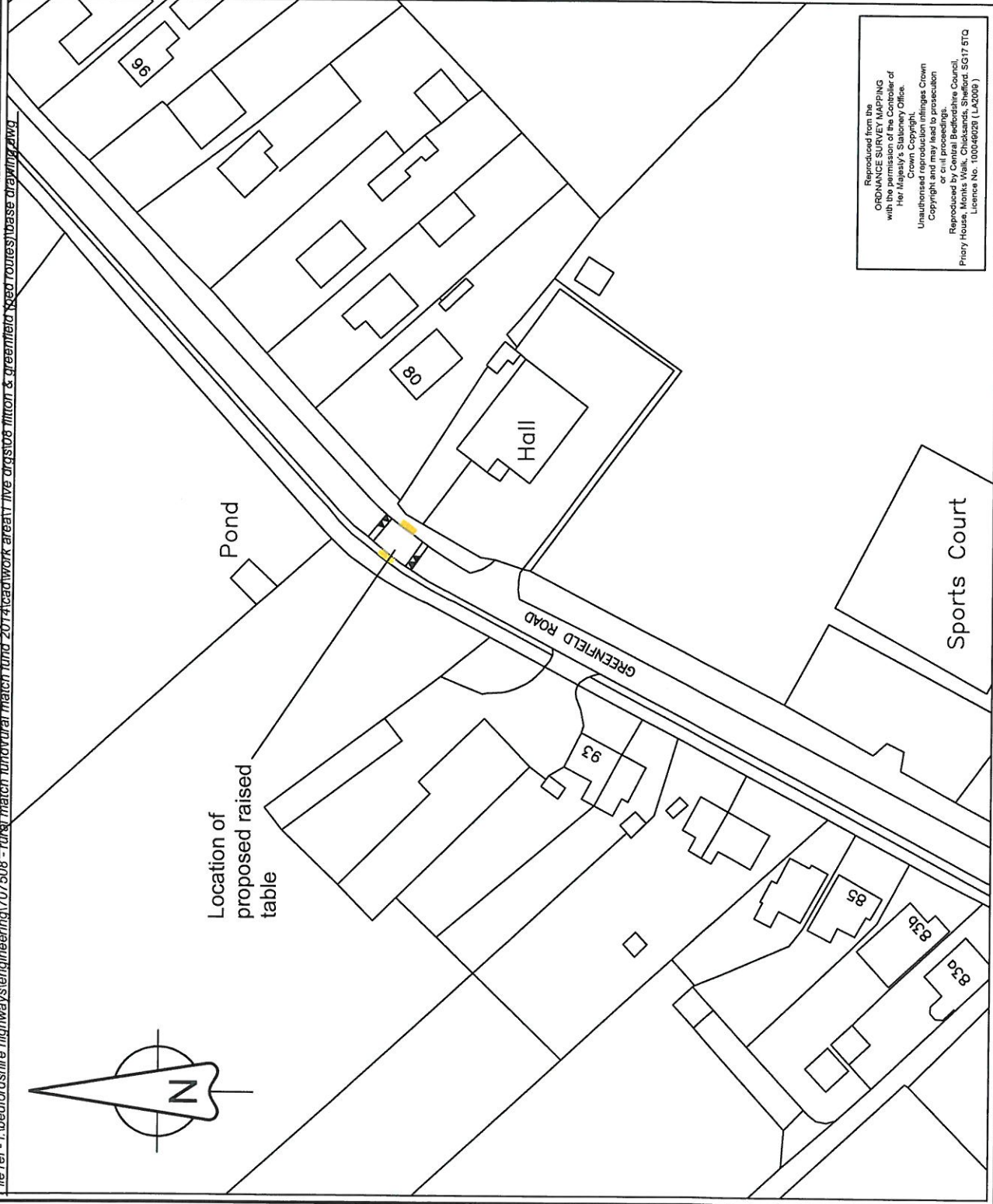

Location of  
proposed raised  
table

Pond

GREENFIELD ROAD

Hall

Sports Court

95

80

93

85

83b

83d

Reproduced from the  
ORDNANCE SURVEY MAPPING  
with the permission of the Controller of  
Her Majesty's Stationery Office.  
Crown Copyright.  
Unauthorised reproduction infringes Crown  
Copyright and may lead to prosecution  
or civil proceedings.  
Reproduced by Central Bedfordshire Council,  
Priority House, Monte Walk, Chickadee, Shefford, SG17 5TQ  
Licensee No. 100460247 (L24006)

